

SEE SCHEDULE "A-11"

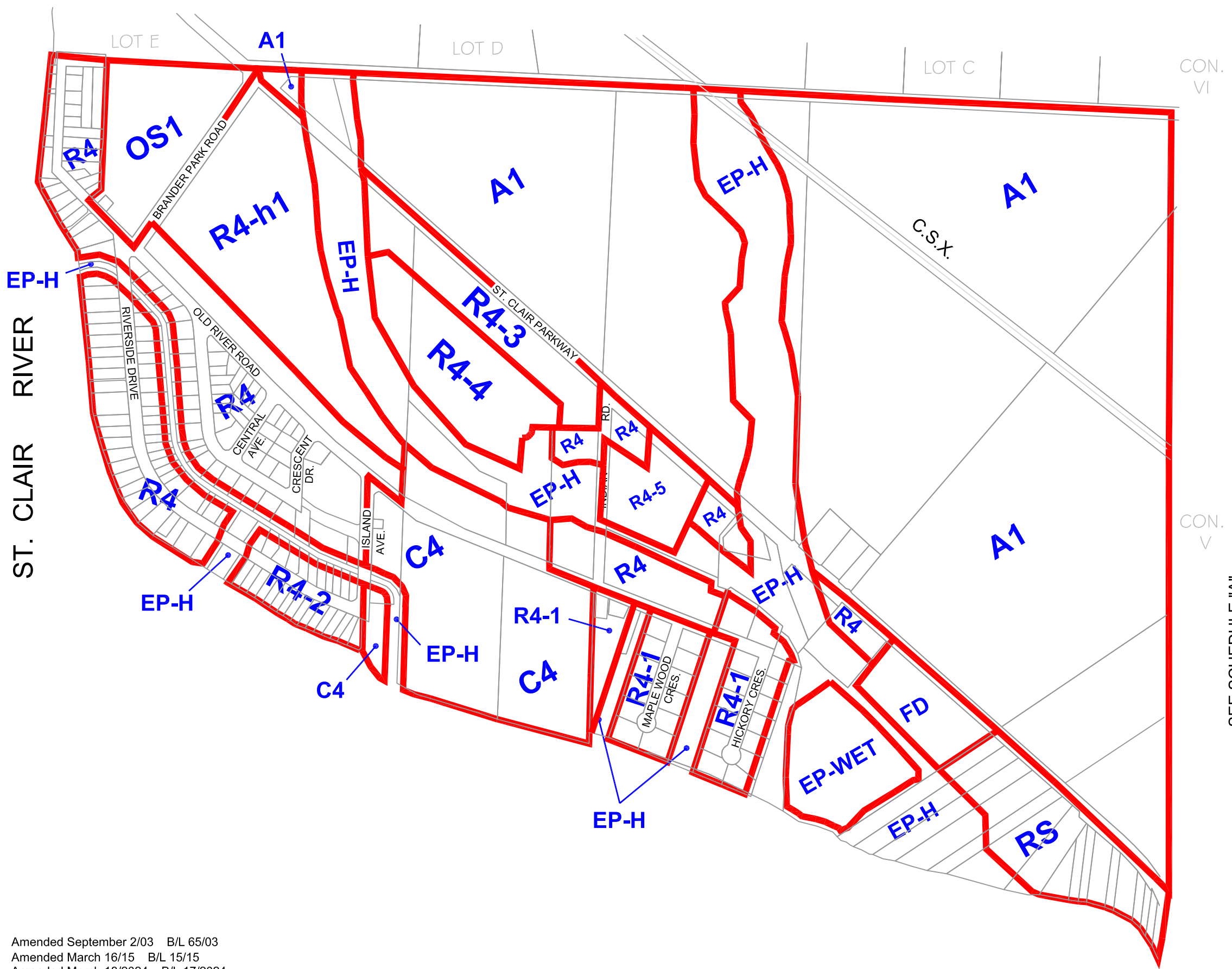

TOWNSHIP OF ST. CLAIR SCHEDULE "A-12" CHENAL ECARTE

TO BY-LAW NO. 17 OF 2003

PASSED THIS 21st DAY OF April, 2003

JOSEPH DEDECKER, MAYOR JOHN DeMARS, CLERK

LEGEND:

ZONE	SYMBOL
AGRICULTURAL - 1	A1
RESIDENTIAL - 1	R1
RESIDENTIAL - 2	R2
RESIDENTIAL - 3	R3
RESIDENTIAL - 4	R4
RESIDENTIAL - 5	R5
RESIDENTIAL - 6	R6
SUBURBAN RESIDENTIAL	RS
INSTITUTIONAL - 1	I1
CENTRAL COMMERCIAL	C1
HIGHWAY COMMERCIAL	C2
AGRICULTURAL COMMERCIAL	C3
WATERFRONT COMMERCIAL	C4
NEIGHBOURHOOD COMMERCIAL	C5
INDUSTRIAL TYPE 1	M1
INDUSTRIAL TYPE 2	M2
INDUSTRIAL TYPE 3	M3
WASTE DISPOSAL INDUSTRIAL	M4
AGRICULTURAL INDUSTRIAL	M5
ENVIRONMENTAL PROTECTION - HAZARD	EP-H
ENVIRONMENTAL PROTECTION - WETLAND	EP-WET
ENVIRONMENTAL PROTECTION - WOODLOT	EP-WD
ENVIRONMENTAL PROTECTION - NATURAL	EP-N
OPEN SPACE - 1	OS1
OPEN SPACE - 2	OS2
FUTURE DEVELOPMENT	FD
HOLDING SYMBOL	h1, h2, ...
EXCEPTIONS	-1, -2, ...

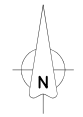
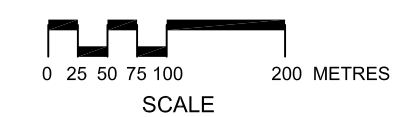

PREPARED BY:
COUNTY OF LAMBTON
PLANNING AND DEVELOPMENT DEPARTMENT
April 21, 2003

Amended September 2/03 B/L 65/03
Amended March 16/15 B/L 15/15
Amended March 18/2024 B/L 17/2024